

# ANTIQUITY 1.6 GPF TOILET

## MODEL NUMBER



**2464.019 ELONGATED**  
**2264.017 ROUND FRONT**  
**2264.217 FLORAL**

ORIGINAL EQUIPMENT  
WATER CONTROL

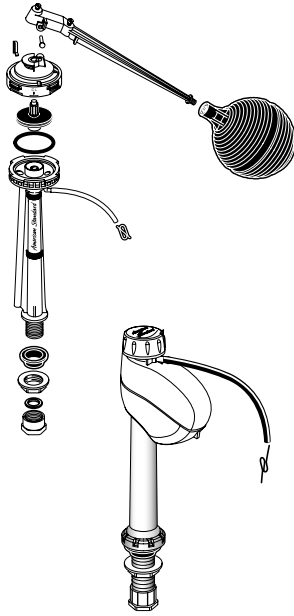

**REPLACEMENT  
SMART VALVE  
3198.000-B**

TANK  
COVER



ORIGINAL  
EQUIPMENT  
TRIP  
LEVER

BOLT  
CAPS

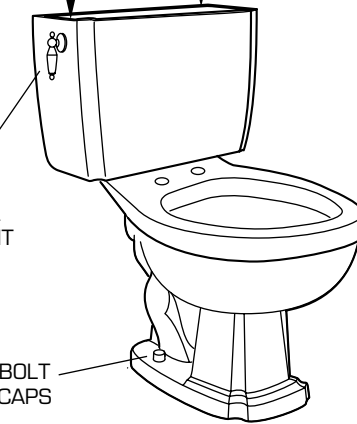

ORIGINAL EQUIPMENT  
FLUSH VALVE



ORIGINAL  
EQUIPMENT  
FLAPPER  
ASSEMBLY

★ Replace XXX with  
Fixture Color Code,  
YYY with Trim Finish

DESCRIPTION	▶ COMPONENT	PKG QTY
★ Elongated Bowl w/Bolt Caps	3208.016.XXX	1
★ Round Bowl w/Bolt Caps	3093.013.XXX	
★ Tank Complete w/Trim	4094.015.XXX	
★ Tank Cover	735036-400.XXX	
ORIGINAL EQUIPMENT REPAIR PARTS	PART NUMBER	PKG QTY
★ Bolt Cap Kit	034783-XXX0A	2
★ Trip Lever (Chrome)	730288-002.XXX	1
★ Trip Lever (Polished Brass)	730288-099.XXX	1
Water Control Assy	738402-0070A	1
Flush Valve	738138-0070A	1
Flapper Assembly	738159-0070A	1

▶ FOR COMPONENT PART ORDERING SEE CURRENT PRODUCT SELECTOR AND PRICING GUIDE.